



©







A larger style two double bedroom semi-detached home, featuring a driveway and a garden to the rear, situated within this ever popular area. Internally the accommodation includes a hall, lounge, dining room and a kitchen whilst to the first floor there are two well-proportioned bedrooms and a bathroom/wc. The property is ideally placed for Sunderland City Centre and within easy reach of the A19, Doxford International Business Park and Nissan, as well as providing an excellent range range of local amenities, including shops and schools. With no upper chain involved, early viewing is highly recommend!

MAIN ROOMS AND DIMENSIONS

Ground Floor

Access via UPVC entrance door into

Reception Hall



Stairs to first floor with storage under and doors to the lounge and kitchen.

Lounge 9'8" x 11'11"



Double glazed window to the front, radiator and feature fireplace. Open plan into the dining room.

Dining Room 8'9" x 7'10"



Double glazed window to the rear, radiator and door to kitchen.

Kitchen 8'0" x 9'7"



Wall and base units with countertops over incorporating a single bowl stainless steel sink and drainer unit with mixer tap. Space for an oven, fridge freezer and washing machine. Double glazed window and UPVC door to rear.

First Floor Landing

Access point to loft and doors to

Bedroom 1 14'2" x 10'1"



Double glazed window to the front, radiator and storage cupboard.

Bedroom 2 10'8" x 10'2"



Double glazed window to the rear and a radiator.

Visit www.peterheron.co.uk or call 0191 510 3323

Tried. Trusted. Recommended. City Branch 20 Fawcett Street Sunderland SR1 1RH Fulwell Branch 15 Sea Road Fulwell Sunderland SR6 9BS

MAIN ROOMS AND DIMENSIONS

Bathroom

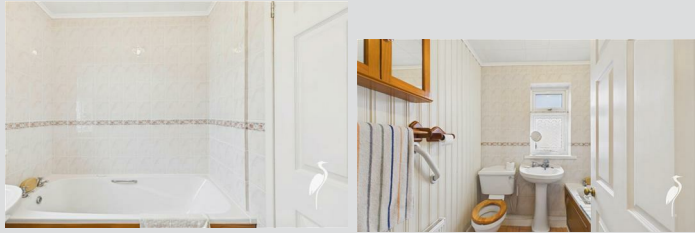

Low level WC, hand wash basin, bath, radiator and a double glazed window to the rear.

Outside



Garden to the front with a gated, paved driveway providing off street parking. Generously sized rear garden laid mainly to lawn benefitting from an outhouse.

Tenure FH

We are advised by the Vendors that the property is Freehold. Any prospective purchaser should clarify this with their Solicitor.

Council TaxBand

The Council Tax is Band A.

Important Notice

Peter Heron Ltd for themselves and for the vendors of this property whose agents they are, give notice that:- The particulars are set out for general guidance only for the intending Purchasers and do not constitute part of an offer or contract. Whilst we endeavour to make our sales

particulars accurate and reliable, if there is anything of particular importance which you feel may influence your decision to purchase, please contact the office and we will be pleased to check the information. Do so particularly, if contemplating travelling some distance to view the property. All descriptions, dimensions, references to conditions and necessary permissions for use and occupation and other details are given in good faith, and are believed to be correct, however any intending purchasers should not rely on them that statements are representations of fact, but must satisfy themselves by inspection or otherwise as to the correctness of each of them. Independent property size verification is recommended.

Lease details, service charges and ground rent (where applicable) are given as a guide only and should be checked and confirmed by your Solicitor prior to exchange of contracts. No person in the employment of Peter Heron Ltd has any authority to make or give any representation or warranty whatever in relation to this property or these particulars, nor to enter into any contract on behalf of Peter Heron Ltd, nor into any contract on behalf of the Vendor. The copyright of all details and photographs remain exclusive to Peter Heron Ltd.

Please note that in the event the purchaser uses the services of Peter Heron Conveyancing in the purchase of their home, Peter Heron Ltd will be paid a completion commission of £300.00 by Movewithus Ltd.

Viewings Fst

To arrange an appointment to view this property contact our Fawcett Street branch on .

Opening Times

Monday - Friday 9.00am to 5.00pm
Saturday 9.00am to 12noon

Ombudsman

Peter Heron Estate Agents are members of The Property Ombudsman and subscribe to The Property Ombudsman Code of Practice.

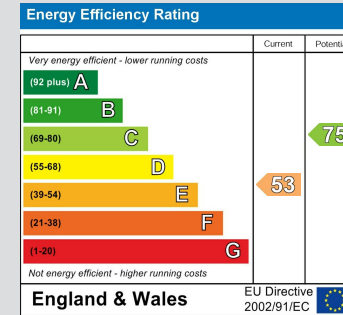

Visit www.peterheron.co.uk or call 0191 510 3323

Tried. Trusted. Recommended. City Branch 20 Fawcett Street Sunderland SR1 1RH Fulwell Branch 15 Sea Road Fulwell Sunderland SR6 9BS

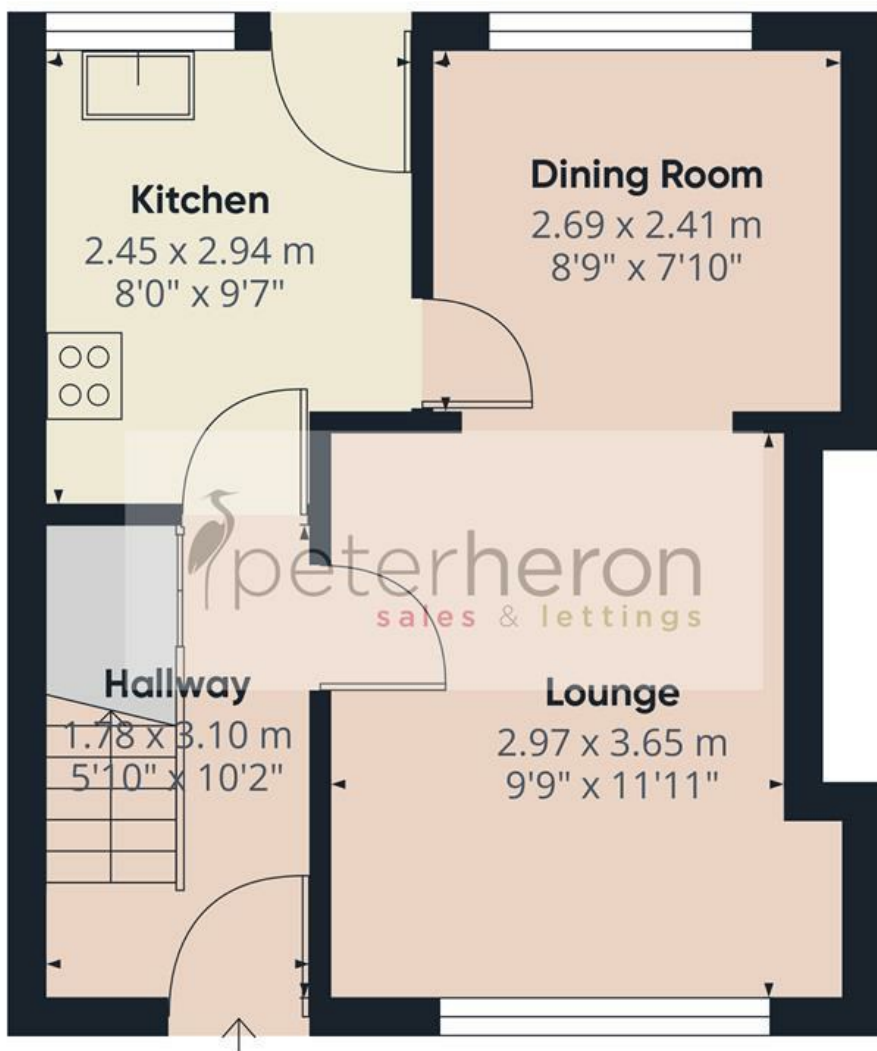

Ground Floor

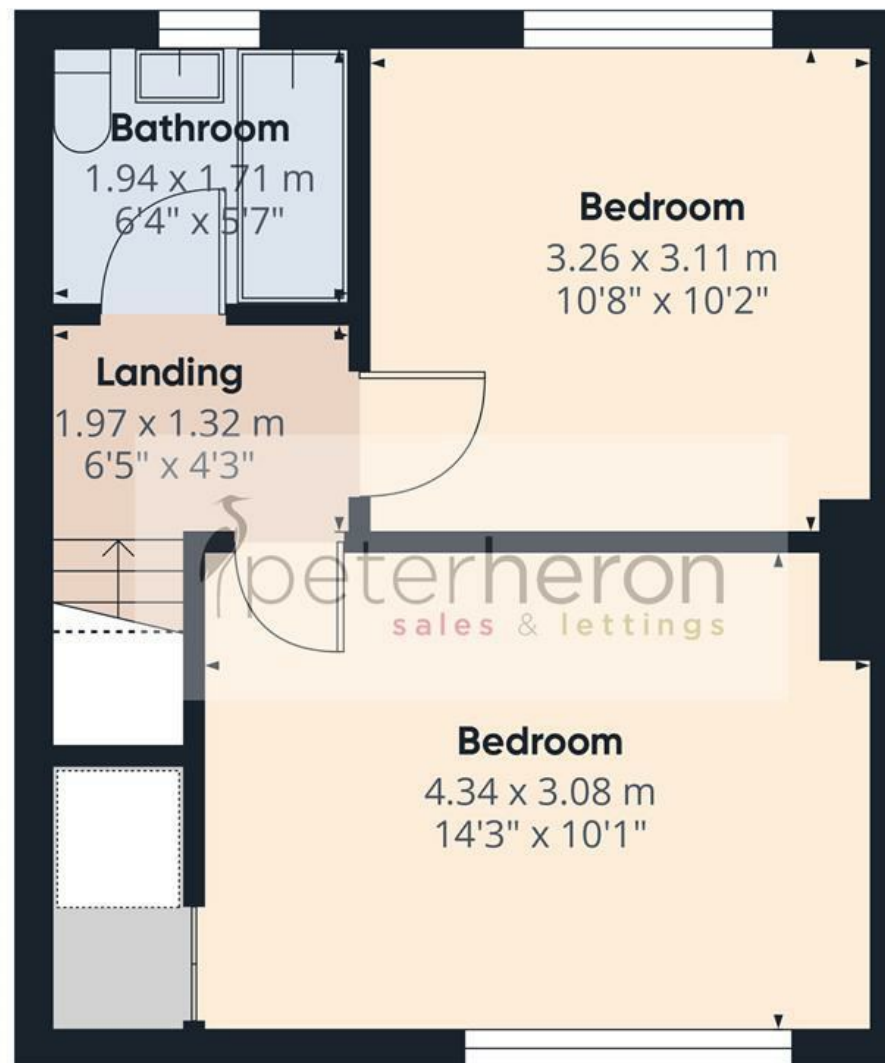

First Floor

Approximate total area⁽¹⁾

60.8 m²

655 ft²

(1) Excluding balconies and terraces

Reduced headroom

..... Below 1.5 m/5 ft

Calculations reference the RICS IPMS 3C standard. Measurements are approximate and not to scale. This floor plan is intended for illustration only.

GIRAFFE360

