









An attractive and well presented two bedroom mid terrace cottage, situated within this popular and convenient location, available with no upper chain involved. The accommodation is all on one level and includes a hall, lounge, kitchen, wet room, wc and two bedrooms. The property benefits from double glazing, gas central heating to radiators and a yard to the rear. This area is ideal for local amenities, shops and schools, Sunderland Royal Hospital, the University and transport connections. Viewing essential.

MAIN ROOMS AND DIMENSIONS

Ground Floor

Access via double glazed entrance door to

Entrance Hall



Radiator and doors leading off to lounge and two bedrooms.

Lounge 13'11" x 11'3" into alcoves



Double glazed windows to the rear, radiator, feature fireplace and door to kitchen.

Kitchen 11'5" x 7'10"



Wall and base units with working surfaces over incorporating a sink and drainer unit, space for cooker, fridge freezer, washing machine and dishwasher, radiator, double glazed window, double glazed door to the courtyard, door to wet room.

Wet Room



Washbasin set into vanity unit and wet area with mains shower, tiled walls and floor, double glazed window and door to WC.

Separate WC



Low level WC, tiled floor, part tiled walls and double glazed window.

Bedroom 1 13'1" x 11'5" not inc wardrobes



Double glazed window to front, radiator and fitted wardrobes.

Visit www.peterheron.co.uk or call 0191 510 3323

Tried. Trusted. Recommended. City Branch 20 Fawcett Street Sunderland SR1 1RH Fulwell Branch 15 Sea Road Fulwell Sunderland SR6 9BS

MAIN ROOMS AND DIMENSIONS

Bedroom 2 10'7" x 5'10"



Double glazed door to rear courtyard and radiator.

Outside



Courtyard to the rear with a remote control roller shutter access door.

Council Tax Band

The Council Tax Band is Band A.

Tenure Freehold

We are advised by the Vendors that the property is Freehold. Any prospective purchaser should clarify this with their Solicitor.

Important Notice Part 1

Items described in these particulars are included in the sale, all other items are specifically excluded. We are unable to verify they are in working order and fit for purpose. The Purchaser is advised to obtain verification from their Solicitor or Surveyor. Please note that in the event the purchaser uses the services of Peter Heron Conveyancing in the purchase of their home, Peter Heron Ltd will be paid a completion commission of £179.00 by Movewithus Ltd. Measurements and floor plans shown in these particulars are approximate and as room guides only. They must not be relied upon or taken as accurate. Purchasers must satisfy themselves in this respect.

Peter Heron Ltd for themselves and for the vendors of this property whose agents they are, give notice that:-

The particulars are set out for general guidance only for the intending Purchasers and do not constitute part of an offer or contract. Whilst we endeavour to make our sales particulars accurate and reliable, if there is anything of particular importance which you feel may influence your decision to purchase, please contact the office and we will be pleased to check the information. Do so particularly, if contemplating travelling some distance to view the property.

Important Notice Part 2

All descriptions, dimensions, references to conditions and necessary permissions for use and occupation and other details are given in good faith, and are believed to be correct, however any intending purchasers should not rely on them that statements are representations of fact, but must satisfy themselves by inspection or otherwise as to the correctness of each of them. Independent property size verification is recommended.

Lease details, service charges and ground rent (where applicable) are given as a guide only and should be checked and confirmed by your Solicitor prior to exchange of

contracts. No person in the employment of Peter Heron Ltd has any authority to make or give any representation or warranty whatever in relation to this property or these particulars, nor to enter into any contract on behalf of Peter Heron Ltd, nor into any contract on behalf of the Vendor. The copyright of all details and photographs remain exclusive to Peter Heron Ltd.

Fawcett Street Viewings

To arrange an appointment to view this property please contact our Fawcett Street branch on 0191 510 3323 or book viewing online at peterheron.co.uk

Opening Times

Monday to Friday 9.00am - 5.00pm Saturday 9.00am - 12noon

Ombudsman

Peter Heron Estate Agents are members of The Property Ombudsman and subscribe to The Property Ombudsman Code of Practice.

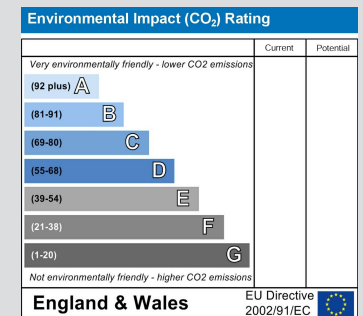
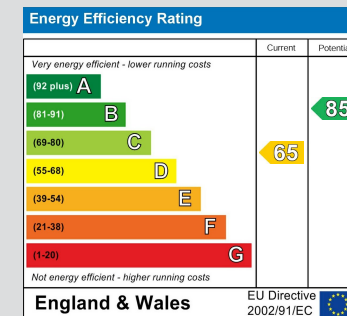

Visit www.peterheron.co.uk or call 0191 510 3323

MAIN ROOMS AND DIMENSIONS



Visit www.peterheron.co.uk or call **0191 510 3323**

Tried. Trusted. Recommended. **City Branch** 20 Fawcett Street Sunderland SR1 1RH **Fulwell Branch** 15 Sea Road Fulwell Sunderland SR6 9BS

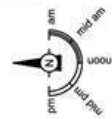
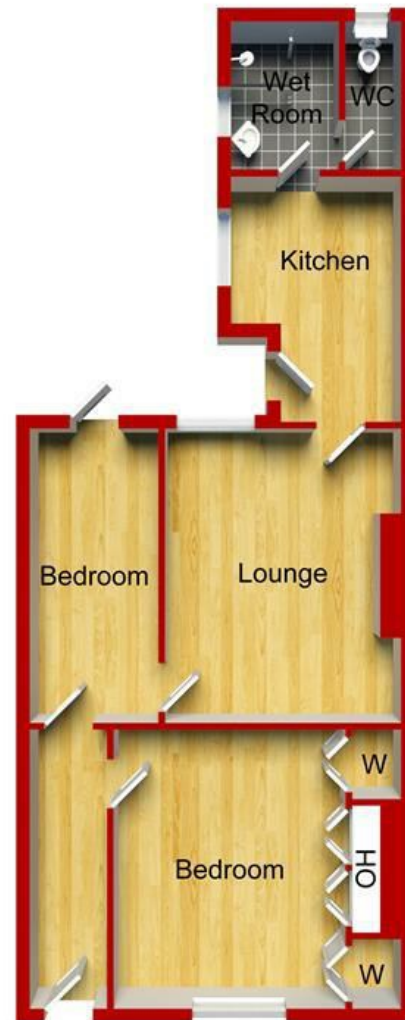

Approximate Floor Area
(58.38 sq.m)

41 Mortimer Street